

DIA 93586



LAND DESCRIPTION	ON	CERTIFICATE IN WHICH LAND IS VESTED	FIELD BOOK
LOT 2 OF ALBANY LOT 1381	PLAN	VOLUME	FOLIO
	DIAGRAM 82297	2038	874
	INDEX BK26(2) 10.04		
	PUBLIC		
			74153
			TOTAL AREA 2285m ²

LOCAL AUTHORITY . TOWN OF ALBANY

LOCALITY . ALBANY

LIMITED IN DEPTH TO 12.19 METRES

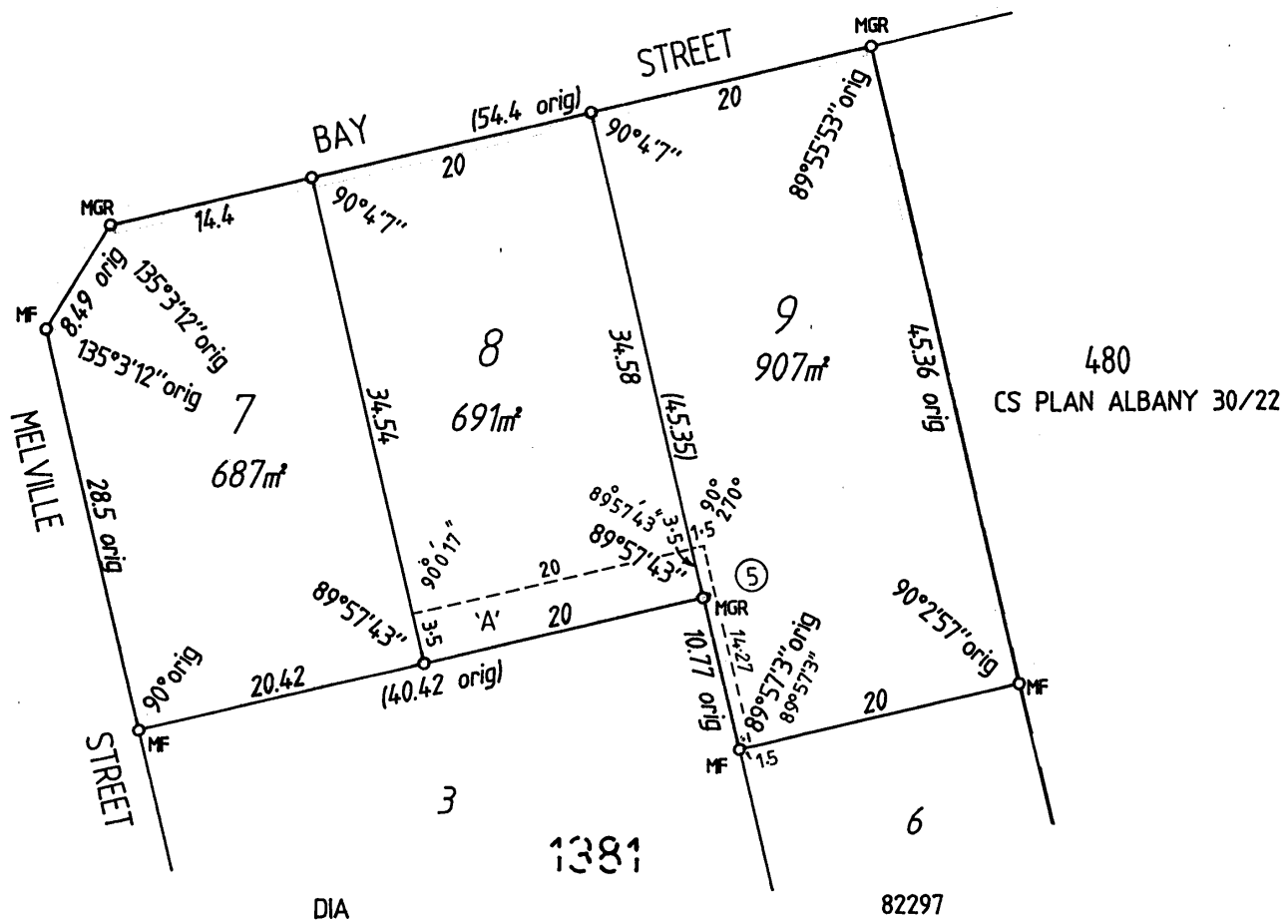

'A' EASEMENT FOR DRAINAGE UNDER SECTION 136C OF THE T.L.A.
BURDEN LOT 8 BENEFIT LOT 7

RE-CERTIFIED CORRECT
(ADDITION OF 136C EASEMENT)

by Britton 31.7.97
FOR INSPECTOR OF PLANS & SURVEYS

⑤ DRAINAGE EASEMENT TO THE TOWN OF ALBANY UNDER SECTION 27A OF THE TP & D ACT REG 5.

JOHN KINNEAR & ASSOCIATES
Consulting Surveyors
11 DUKE STREET
PO BOX 1429
ALBANY WA 6331
PHONE (098) 42 1353 FAX (098) 42 1570
ACN 009 195 653



OUR REF 1102

<p>M. ANDERSON</p> <p>hereby certify that (REG. 54)</p> <p>(a) this plan of survey is a correct and accurate representation of the survey carried out by me personally/ or under my own personal supervision, inspection and field check, and recorded in Field Books lodged for the purposes of this plan of survey.</p> <p>(b) the measurements are in strict accordance with the Licensed Surveyors (Guidance of Surveyors) Regulations 1961 and in particular regulations 23 and 34 of those regulations; and</p> <p>(c) this survey and this plan of survey are in strict accordance with the requirements of the Licensed Surveyors (Guidance of Surveyors) Regulations 1961 and the relevant law in relation to which it is lodged.</p> <p><i>M. Anderson</i> 6/6/97 LICENSED SURVEYOR DATE</p>	<p>hereby certify that (REG. 55D)</p> <p>(a) this plan is correct and was prepared under my supervision and is the result of calculations from measurements made by me personally/ under my own personal supervision, inspection and field check as recorded in the field books lodged for the purposes of this plan;</p> <p>(b) the measurements are in strict accordance with the requirements of the Licensed Surveyors (Guidance of Surveyors) Regulations 1961 and in particular regulations 23 and 34 of those regulations; and</p> <p>(c) this plan of survey conforms with the relevant law in relation to which it is lodged.</p> <p>..... LICENSED SURVEYOR DATE</p>	<p>APPROVED BY</p> <p>WESTERN AUSTRALIAN PLANNING COMMISSION</p> <p>FILE 99944</p> <p><i>Eugene Jensen</i> FOR CHAIRMAN DATE 5-8-97</p> <p>99944</p>	<p>LODGED</p> <p>DATE 12.6.97</p> <p>FEE PAID \$ 298</p> <p>ASSESS No 163724</p> <p>TYPE OF VALIDATION</p> <p>FULL AUDIT</p> <p>LEGAL COMPONENT N. D. TUCKER</p> <p>DOCKET PLAN/DIAGRAM 93152</p> <p>CERTIFIED CORRECT <i>A. Scullion</i> 9/7/97</p> <p>F.S.C. No</p> <p> DOLA Department of LAND ADMINISTRATION</p>	<p>SCALE 1500</p> <p>ALL DISTANCES ARE IN METRES</p> <p>IN ORDER FOR DEALINGS</p> <p>SUBJECT TO SEC 27A OF T.P. & D. ACT & SEC 136C OF T.L.A.</p> <p><i>by Britton</i> 7.8.97 FOR INSPECTOR OF PLANS & SURVEYS DATE</p> <p>APPROVED 8.8.97</p> <p>APPROVED INSPECTOR OF PLANS & SURVEYS</p> <p>OFFICE OF TITLES DIAGRAM</p> <p>93586</p>
--	--	--	--	--